

nrp

10

4/207

DRG NO. **10**  
 SHEET NO.  
 PART LAYOUT PLAN

BALLIA  
 SHEET NO.  
 PART LAYOUT PLAN

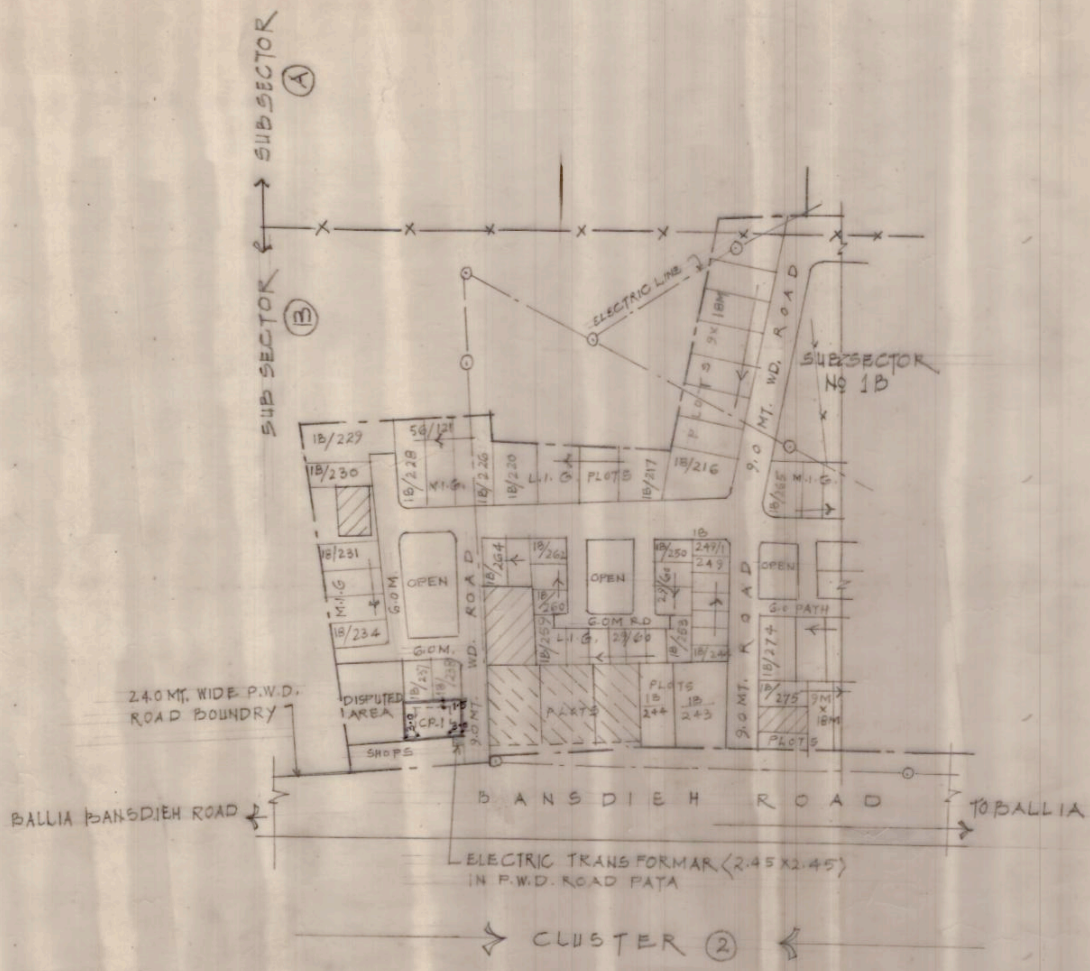

REVISION - 1  
 1. THIS REVISION FOR PLOT NO. CP-1 HAS BEEN MADE ACCORDING TO THE INFORMATION RECEIVED BY B.E. CD.34 VIDE HIS LETTER NO. 503/7.15/05 DT. 27.3.2002.  
 2. SET BACKS ARE SHOWN ON PLOT NO. CP-1  
 3. NO. OF FLOORS ALLOWED G+1.  
 4. TOTAL HEIGHT - 7.50 MTS.  
 5. PARKING SHALL BE 15 PER 300 SPT 2002.  
 6. SET BACK AS SHOWN IN PLAN.  
 SET BACKS : FOR PLOT NO - CP-1.  
 FRONT - 3.0 MTS  
 REAR - 3.0 MTS  
 SIDE - 1.50 MTS.

SCALE 1:1000  
 ARCHITECTURE & PLANNING UNIT-2  
 U.P. AVAS EVAM VIKAS PARISHAD, LKO.  
 PART LAYOUT PLAN FOR HARPUR  
 BHOOMI VIKAS EVAM GRIHSTHAN  
 YOJNA, BALLIA.

DEALT BY	SHAHEENA
CHECKED BY	
DATE	10.01.03
PADAM MOHAN F.I.I.A. ASST. ARCH. PLANNER	<i>Padam Mohan</i>
S.C. SRIVASTAVA G.D. ARCH. A.I.I.A. INCHARGE A.P. UNIT-2	<i>S.C. Srivastava</i> 14/1/03
REKHA PANT B. ARCH. SR. ARCH. PLANNER	- SD - 14.1.03
SUBODH SHANKAR B. ARCH. (HONS) F.I.T.P. F.I.I.A. CHIEF ARCH. PLANNER	- SD - 15.1.03
V.N. GARG I.A.S. AVAS AYUKT	- SD - 16.1.03

3



4



8

HARPER BHOMI VIKAS EVAM GRISHTHAN YOTNA BALLIA

DRO. NO. SHEET NO  
BABA-01/04 PART LAYOUT PLAN

NOTE:- REVISION-1

THIS LAY-OUT PLAN HAS BEEN PREPARED ACCORDING TO THE INFORMATION RECEIVED BY E.E.C.D BY VIDE HIS LETTER NO. 3290/DT-15/189 DATED 31-12-2007

REVISION-1

THIS PART LAYOUT PLAN FOR PLOT NO. 2B/148/1 AND 2A/292/1, 2A/232/2 HAS BEEN PREPARED ACCORDING TO THE MENTIONED LETTER ABOVE.

SCALE: 1:1000

ARCHITECTURE & PLANNING UNIT-2  
U.P. WAJE EVM VIKAS PANSI HADY, LUCKNOW

PART LAY-OUT PLAN FOR HARPER BHOMI VIKAS EVAM GRISHTHAN YOTNA BALLIA

DEALT BY SHARERNA

CHECKED BY

DATE 06.01.04

PADAM MOHAN  
F.H.A.

ASST. ARCH. PLANNER

C.N. HARDE  
P. ARCH.

ARCHITECT PLANNER

SUBODH SHANKAR  
B. ARCH. (HONS) P.H.T.P.

F.H.A.  
CHIEF ARCH. PLANNER

15.3.04

REVISION 1

THIS LAY OUT PLAN HAS BEEN PREPARED ACCORDING TO THE INFORMATION RECEIVED BY E.E.C.D. BY VIDE HIS LETTER NO. 1076/Y-15/64 DATED 5/5/04

with aw.		
PADAM MOHAN A.P.	C.N. HARDE A.P.	SUBODH SHANKAR C.A.P.

