

SECTOR-5 SECTOR-4



UPAVP
 ARCHITECTURAL AND PLANNING SECTION
 NEELGIRI COMPLEX, INDIRA NAGAR
 LUCKNOW-226016
 Email : uphdb@sanchamet.in

DRG. NO. NUMBERING PLAN FOR SHANJAHANPUR
 SHEET NO. NUMBERING PLAN

FILE: \\Upbdb-epdserver\data temp\UNIT-2\SHANJAHANPUR

- NOTE :-
1. THIS NUMBERING LOP HAS BEEN PREPARED ON THE BASIS OF FEASIBILITY/SURVEY RECEIVED FROM EXER.N.K.-36 VIDE HIS LETTER NO.-1007/W-2/46, DATED-07.07.05.
 2. THIS NUMBERING LOP HAS BEEN PREPARED ON THE BASIS OF FEASIBILITY/SURVEY RECEIVED FROM EXER.N.K.-36 VIDE HIS LETTER NO.-1007/W-2/46, DATED-07.07.05.
 3. ANY DISCREPANCY, IF FOUND IN THE CONSTRUCTION PERIMETRES MAY IMMEDIATELY BE BROUGHT TO THE NOTICE OF ARCHITECTS PLANNER UNIT TWO.

ARCHITECTURE & PLANNING UNIT-1
U.P. AVAS EVAM VIKAS PARISHAD,
 NUMBERING PLAN OF SECTOR-1&5, FOR BAREILY BYE PASS
 ROAD YOJNA NO.-3. SHAHJAHAN PUR

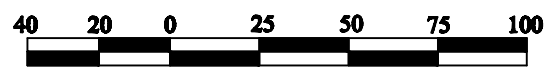

DEALT BY: V.B.PATHAK DATE: AUG.22,2005. DRG.NO.

| | |
|--|-------------|
| HEMA SHAH DIP.ARCH. ASSTT. ARCHITECT PLANNER | sd- |
| VIJAY PANDEY DIP.ARCH. ASSTT. ARCHITECT PLANNER | sd- 22.8.05 |
| C.N.HARDE B. ARCH. ARCHITECT PLANNER | sd- 25.8.05 |
| SUBODH SHANKAR B. ARCH.(HONS.), F.I.L.A., I.T.P. CHIEF ARCHITECT PLANNER | sd- 25.8.05 |

BARADARI
AREA - 6780.00 SQM.

area 4305.00 sqm.

RESIDENTIAL PLOTS
(12.00x24.00 M)



UPAVP

ARCHITECTURAL AND PLANNING SECTION
NEELGIRI COMPLEX, INDIRA NAGAR
LUCKNOW-226016
Email : uphdb@sanchamat.in

DRG. NO.

NUMBERING PLAN FOR
SHAHJAHANPUR
SHEET NO.
NUMBERING PLAN

FILE: \\Uphdb-epsdserver\data temp\UNIT-2\SHAHJAHANPUR

NOTE -
THIS NUMBERING PLAN HAS BEEN PREPARED
ON THE BASIS OF FEASIBILITY RECEIVED FROM
E.R. NIRMAN KHAND-36, VIDE HIS LETTER
NO. 1531/Y-3/157, DTD. 13.12.2007.

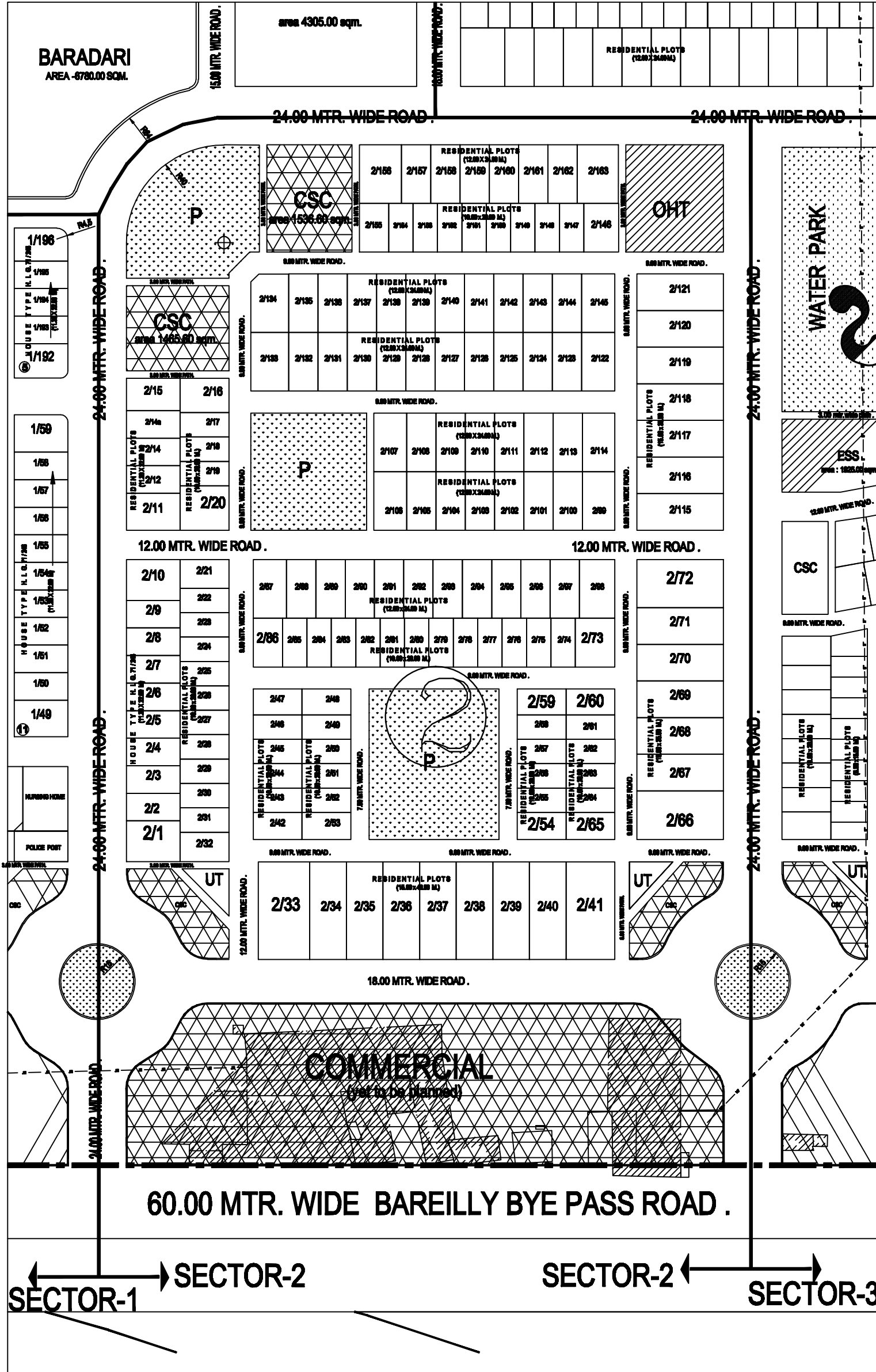

ARCHITECTURE & PLANNING UNIT-2
U.P. AVAS EVAM VIKAS PARISHAD,
PROPOSED NUMBERING PLAN OF SECTOR-2, FOR BAREILLY
BYE PASS ROAD YOJNA NO.3.SHAHJAHAN PUR



DEALT BY:
V.B.PATHAK

DATE: 22/01/08
DRG.NO.



P.K.SINGH NAGLAKAR
B.ARCH.MPLAN(URP)
ASSTT. ARCHITECT PLANNER

GOPAL GARG
B.ARCH.
ARCHITECT PLANNER (INCHARGE)

SD.-23-01-2008

CHIEF ARCHITECT PLANNER

ANIL SANT
L.A.S.
AVAS AYUKT

SECTOR-1 → SECTOR-2

SECTOR-2 ← SECTOR-3

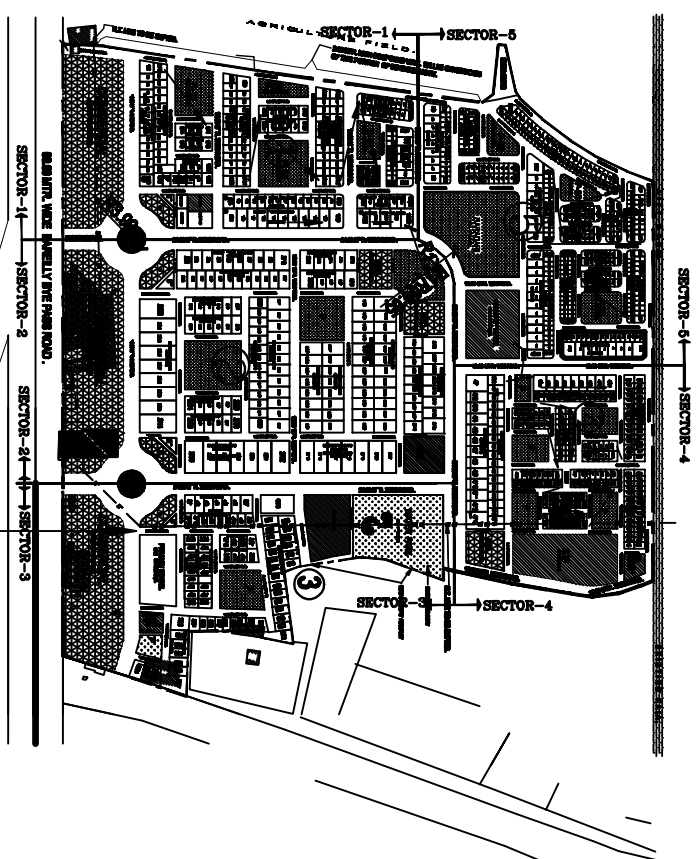
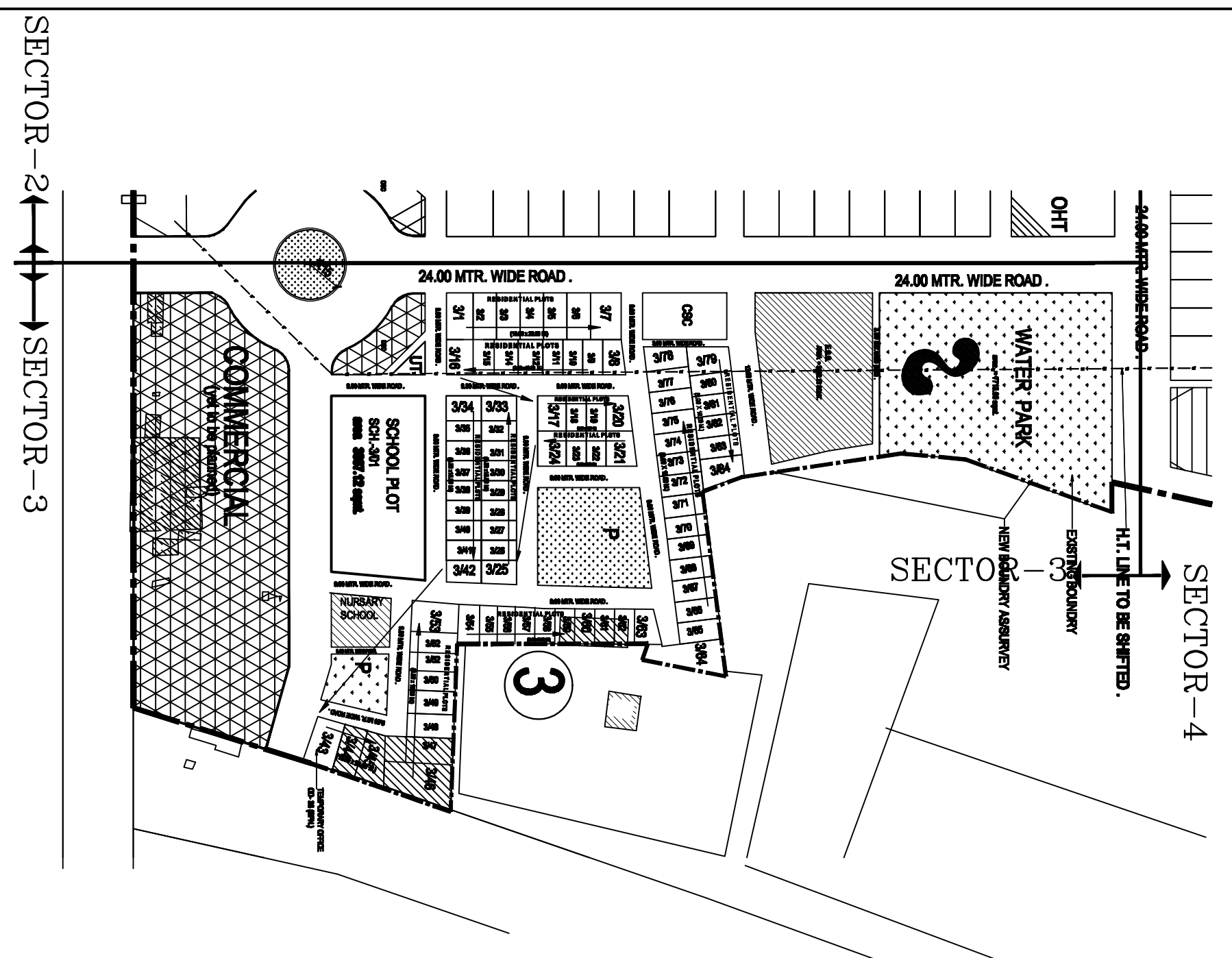

KEY PLAN
PROPOSED SITE

REVISION NOTE -08-04-2008
THIS REVISED NUMBERING PLAN HAS BEEN PREPARED ON THE BASIS OF INFORMATION RECEIVED FROM E.E. NIRMAN KHAND-36, VIDE HIS LETTER NO. 388/ Y-3/29, DATED, 27.03.2008.

| | | | |
|--------------------------------------|---|-------------------------------|---------------------------|
| SD-08-04-2008 | | SD-08-04-2008 | |
| V.A. GAUTHAM/SHRUTI (ARCHT ASSTT) | P. K. SINGH NAGE/ARJUN (A.A.P/PLANNER) | GOPAL GARG (A.P. INCHARGE) | ANIL SANT (AVAS AYUKT) |

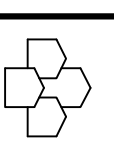

UPAVP
ARCHITECTURAL AND PLANNING SECTION
NEELGIRI COMPLEX, INDIRA NAGAR
LUCKNOW-226016
Email : uphd@sanchannel.in

| | |
|-----------|-------------------------------------|
| DRG. NO. | L.O.P. & NUMBERING PLAN OF SECTOR-3 |
| SHEET NO. | SEKHAJAYANR |

NOTE -
THIS REVISED LAYOUT AND NUMBERING PLAN HAS BEEN PREPARED ON THE BASIS OF FEASIBILITY RECEIVED FROM E.E. NIRMAN KHAND-36, VIDE HIS LETTER NO. 1521/Y-3/156 DTD. 12.12.2007.

| PROPOSED PROPERTY DETAILS | | | | |
|---------------------------|------------|-------------|-------------|-----------|
| S.NO | TYPE | SIZE | AREA | NOS |
| 1. | RESI. PLOT | 10.0X20.0 m | 200.0 Sqmt. | 10 |
| 2. | RESI. PLOT | 9.0X18.0 m | 162.0 Sqmt. | 29 |
| 3. | RESI. PLOT | 8.50X15.0 m | 127.5 Sqmt. | 44 |
| TOTAL | | | | 83 |

LEGEND

| | |
|--|---------------------------|
| | SECTOR BOUNDARY |
| | ENCROACHMENT/UNAUTHORISED |
| | GREEN |

APPROVED & PLANNED UNDER LICENSE.
REVISED L.O.P. & NUMBERING PLAN OF SECTOR-3, FOR BARILLY BYE PASS ROAD YONA NO.-3, SHAHAJAHANPUR

| | | | |
|---|--|-------|--|
| DATE: 22-01-08 | | NORTH | |
| DATE: 22-01-08 | | NORTH | |
| <p>ARCHT. ASSISTANT</p> <p>P. K. SINGH NAGE/ARJUN P. ANEEL K. PLAN (D.D.) ASSTT. ARCHTCT PLANNER</p> <p>ARCHTCT PLANNER (INCHARGE)</p> <p>GOPAL GARG P. ANEEL ARCHTCT PLANNER (INCHARGE)</p> <p>SD-23-01-2008</p> | | | |

CHIEF ARCHTCTCT PLANNER
ANIL SANT
L.A.
AVAS AYUKT

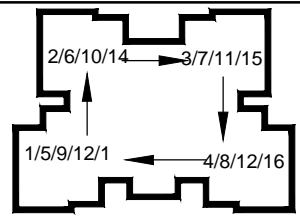

PATTERN FOR NUMBERING PLAN.

NOTE

1. RESIDENTIAL COMPLEX DESIGN LAYOUT IS PREPARED ON THE BASIS OF PARAMETERS DECIDED BY G.O. - 5376/9-5-08-153 SA/2008 DATED - 24-07-08 AND BY G.O. 7393A, /9-5-08-153 SA/08 T.C. DATED - 08-10-08.
2. BLOCK LAYOUTS/ ROAD SECTIONS PROVIDED IN THIS LAYOUT AS PER APPROVED DESIGN.
3. FACILITIES WHICH ARE NOT PROVIDED IN THIS LAYOUT WILL BECOME PART IN FUTURE SURROUNDING DEVELOPMENT PLAN AS AREA PROVIDED FOR SCHEME IS LIMITED TO THIS SITE ONLY
4. ONLY WRITTEN DIMENSIONS TO BE FOLLOWED AND ANY DISCREPANCY, IF FOUND ON THE SITE SHOULD BE IMMEDIATELY REFERRED TO ARCHITECTURE AND PLANNING UNIT-2, MORADABAD



ISO .9001 - 2000

UPHDB

ARCHITECTURAL AND PLANNING SECTION
UNIT-2, F- 27,28, LAJPAT NAGAR,
MORADABAD-244001.

E-mail:- apunit2@reddifmail.com

DATE:-
15.05.2009

PROPOSED NUMBERING PLAN FOR MANANIYA SHRI
KASHIRAM YOJNA AT BAREILLY BYE PASS ROAD YOJNA
NO.-3, SECTOR-4, SHAHJAHANPUR.

SHEET NO. 01
DRG. NO. -

NOTE

1. THIS NUMBERING PLAN HAS BEEN PREPARED ON THE BASIS OF INFORMATION RECIEVED FROM E.E.CD.-23, MORADABAD VIDE HIS LETTER NO. 1635/KA.RA.YO/ 632, DATED. 30.04.09. & S.E.CIR.-V VIDE HIS LETTER NO.1307/K.SHAHJAHANPUR, DATED-15.05.09.

SECTOR-4

TOTAL AREA = 5.2920 HECT.
NO. OF FLATS = 1504 NOS.
NO. OF STORIES = G+3

LEGEND:-

= BLOCK SHALL BE CONSTRUCTED AFTER THE APPROVAL OF DY. HOUSING COMMISSNER'S ORDER FOR SHIFTING THE AFFECTED PLOT NO.- 4/ 83, 4/ 84, 4/ 98, 4/ 100.

SECTOR-5 ← SECTOR-4

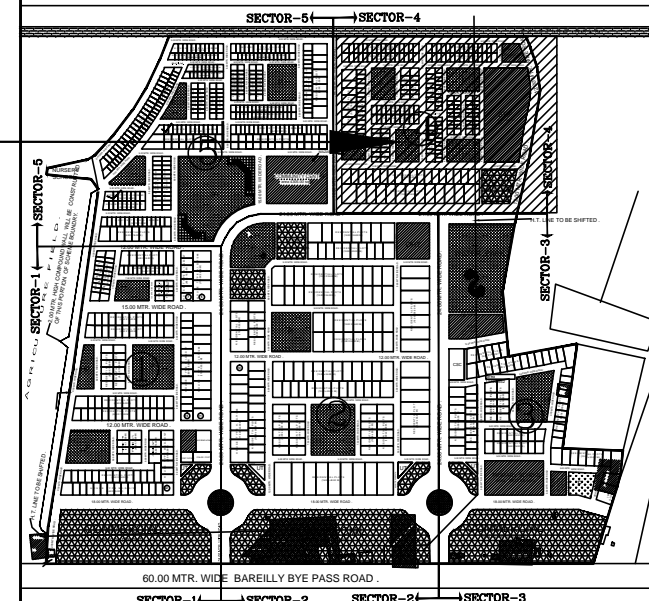
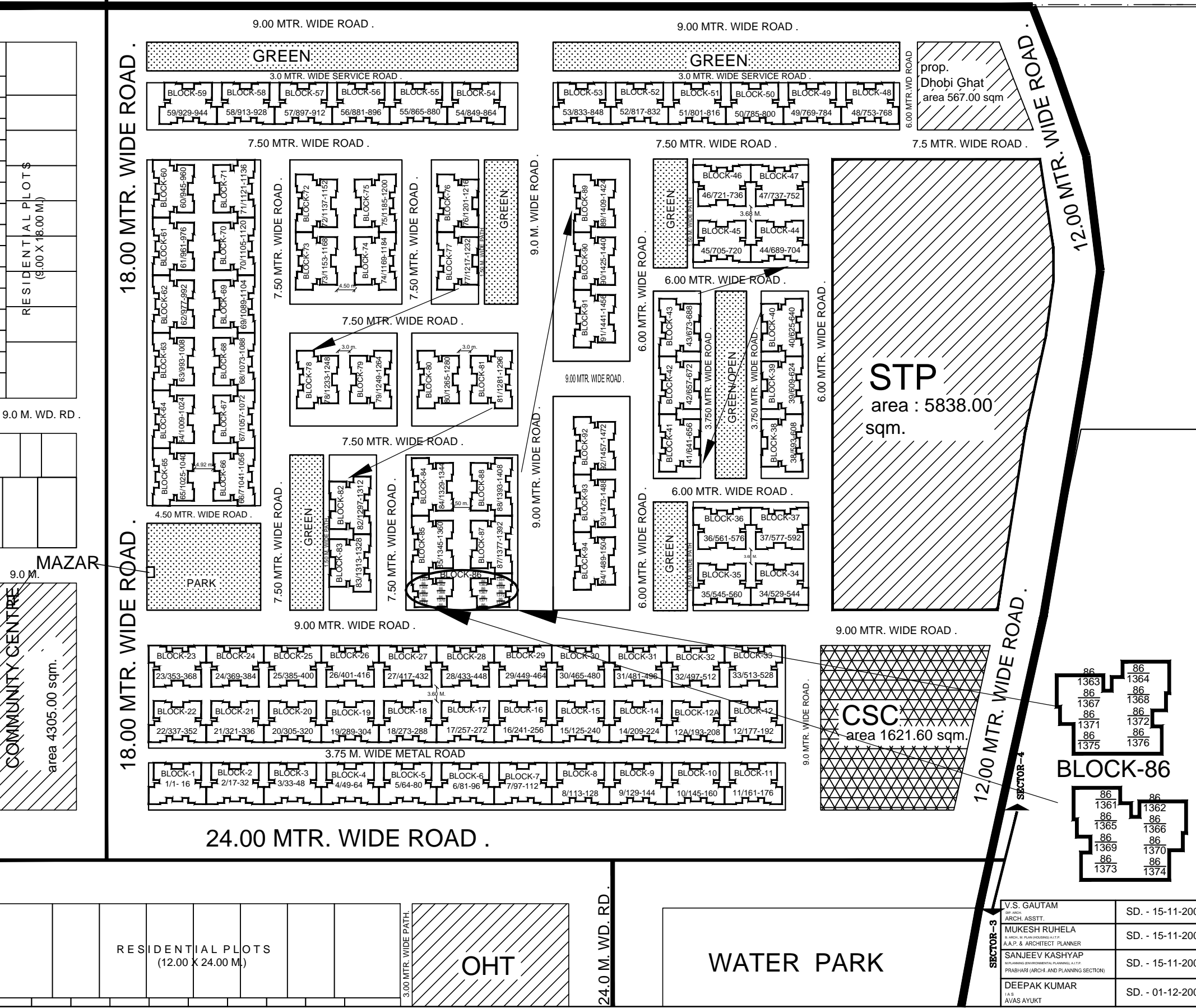

ARCHITECTURE & PLANNING UNIT-II
U.P. AVAS EVAM VIKAS PARISHAD, MORADABAD.

PROPOSED NUMBERING PLAN FOR MANANIYA SHRI KASHIRAM SAHRI
GARIB AVASIYA YOJNA AT BAREILLY BYE PASS ROAD YOJNA NO.-3,
SECTOR-4, SHAHJAHANPUR.



| | |
|--|--|
| DEEP MALA DIP. ARCH. ARCH. ASSTT. | |
| MUKESH RUHELA B. ARCH., M. PLAN (HOUSING) A.I.T.P. ARCHITECT PLANNER | |
| SANJEEV KASHYAP M.PLANNING (ENVIRONMENTAL PLANNING), A.I.T.P. SENIOR ARCHITECT PLANNER | |
| C.P.SHARMA M.L.R.PLANNING A.I.T.P. CHIEF ARCHITECT PLANNER | |

| | |
|---|------------------|
| V.S. GAUTAM A.P. & ARCHITECT PLANNER | SD. - 15-11-2008 |
| MUKESH RUHELA A.P. & ARCHITECT PLANNER | SD. - 15-11-2008 |
| SANJEEV KASHYAP M.PLANNING (ENVIRONMENTAL PLANNING), A.I.T.P. PRABHARI (ARCH. AND PLANNING SECTION) | SD. - 15-11-2008 |
| DEEPAK KUMAR J.A.S AVAS AYUKT | SD. - 01-12-2008 |

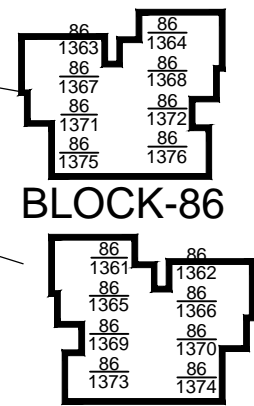

SECTOR-5
SECTOR-4

L I F T C A N A L

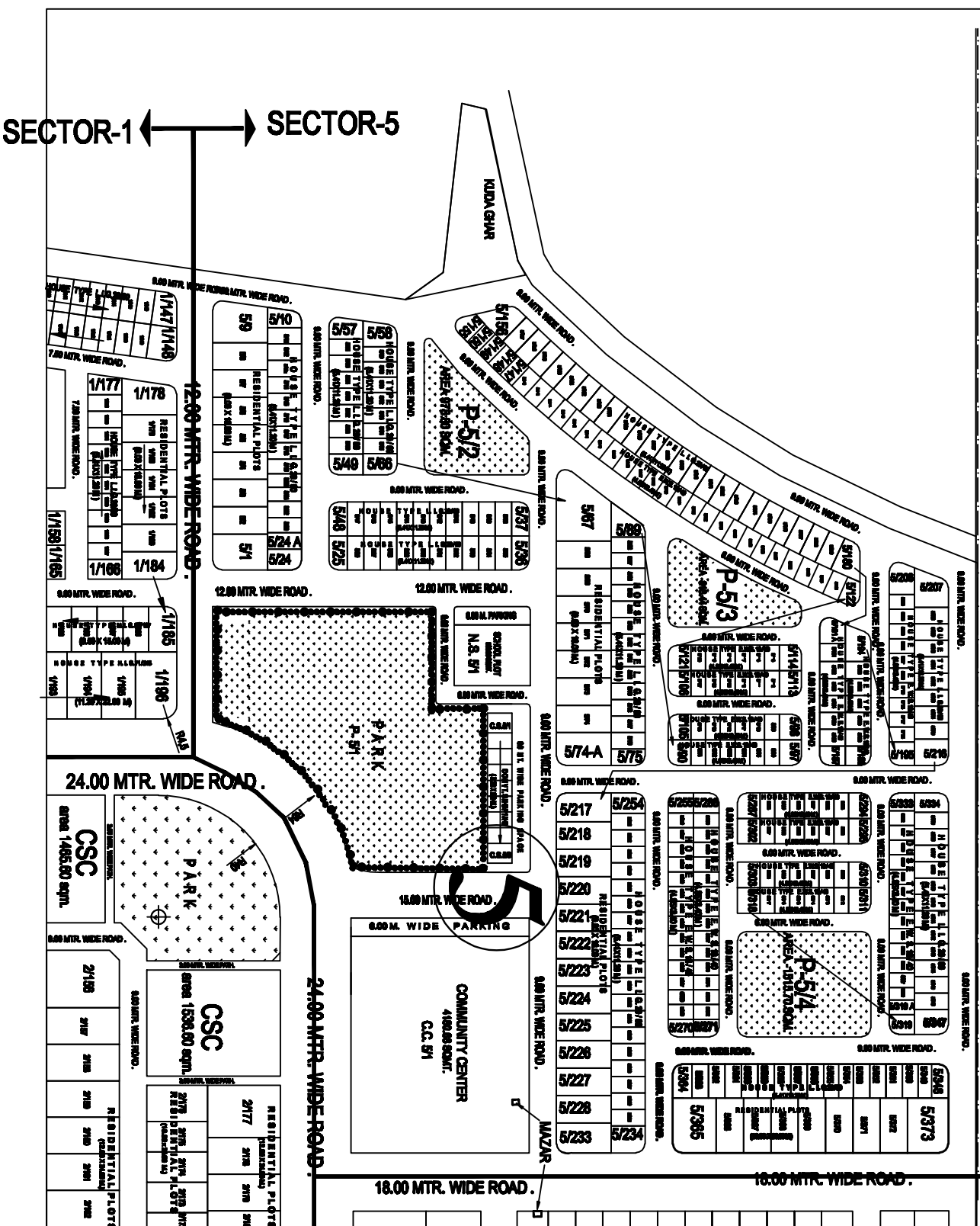

SECTOR - 5 NUMBERING PLAN

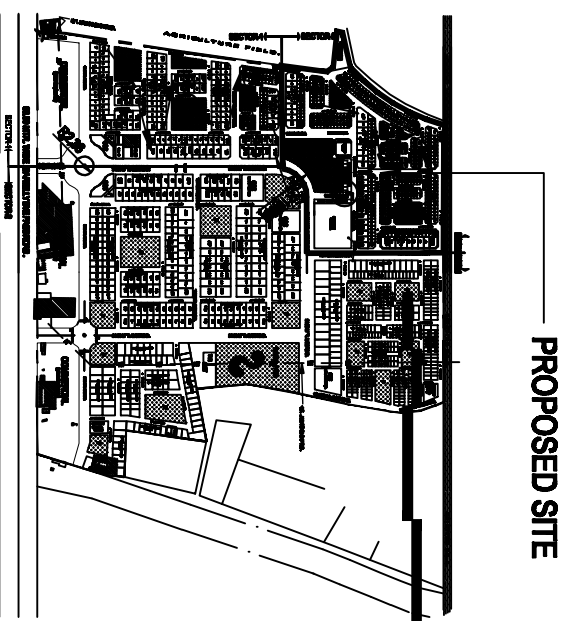

UPAVP
ARCHITECTURAL AND PLANNING SECTION
NEELGIRI COMPLEX, INDIRA NAGAR
LUCKNOW - 226016
Email : upavp@rediffmail.in

DRG. NO. **REPROPOSED NUMBERING PLAN**
SHEET NO. **SEAWATER**
NUMBERING PLAN

NOTE -
THIS NUMBERING PLAN HAS BEEN PREPARED ON THE BASIS OF FEASIBILITY RECEIVED FROM E.E. NIRMAL KHAND-36, VIDE HIS LETTER NO. 1531/Y-3/157, DTD. 13.12.2007.
THIS NUMBERING PLAN HAS BEEN PREPARED ON THE BASIS OF FEASIBILITY RECEIVED FROM E.E. NIRMAL KHAND-36, VIDE HIS LETTER NO. 41/Y-3/19, DTD. 09.01.2008.

ARCHITECTURE & PLANNING UNIT-II
U.P. AVAS EVAM VIKAS PARISHAD,
PROPOSED & REVISED NUMBERING I. O.P FOR BARBELLY
BYE PASS ROAD YONA NO.-3, SEC. 5, SHAHDHAN PUR.

DATE: 17-01-08
DRAWN BY: SMITVA
DATE: 17-01-08
DRG. NO.

20 10 0 20 100 M.

P. K. SINGH NAGAIKAR
E. ASST. ARCHITECT PLANNER
GOPAL GARG
E. ASST. ARCHITECT PLANNER (CONTRACTOR)
SD.-23-01-2008

CHIEF ARCHITECT PLANNER
ANIL SANT
E. ASST. AVAS OFFICER