

THE LAND OFFICE OF THE GOVERNMENT OF THE NETHERLANDS
 has received an application for a building permit for the construction of a building on the site of the former 'De Oude Schuur' in the town of Alkmaar, in the province of Noord-Holland.

THE LAND OFFICE OF THE GOVERNMENT OF THE NETHERLANDS
 has received an application for a building permit for the construction of a building on the site of the former 'De Oude Schuur' in the town of Alkmaar, in the province of Noord-Holland.



1. Name of the applicant: ...
 2. Name of the building: ...
 3. Address: ...
 4. Description of the building: ...
 5. Date of application: ...

No.	Name	Area	Remarks
1	Plot 1
2	Plot 2
3	Plot 3
4	Plot 4
5	Plot 5
6	Plot 6
7	Plot 7
8	Plot 8
9	Plot 9
10	Plot 10

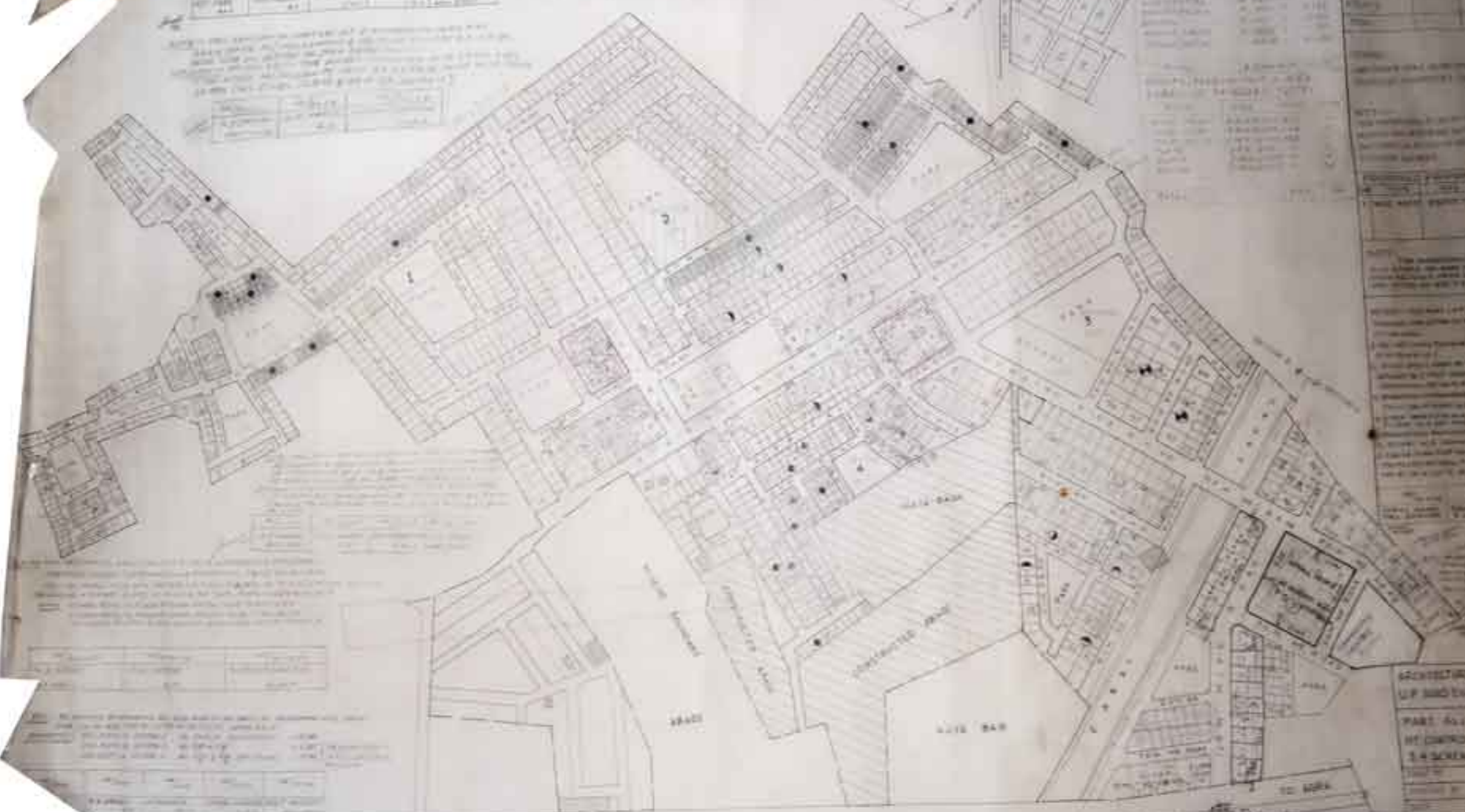

The applicant is requested to provide the following information: ...
 - A detailed architectural plan of the building ...
 - A site plan showing the location of the building on the plot ...
 - A plan of the surrounding area showing the location of the plot ...

ARCHITECTURE AND PLANNING OF
 UP AND DOWN STAIRS

PART ALLOTMENT REGULATIONS
 BY CONTROL PLAN FOR SECTION
 IN SECTION 112 (1924)

No.	Name	Area	Remarks
1	Plot 1
2	Plot 2
3	Plot 3
4	Plot 4
5	Plot 5
6	Plot 6
7	Plot 7
8	Plot 8
9	Plot 9
10	Plot 10

DE ALBANI 24 METER WIDE EXISTING AREA

No.	Name	Area	Remarks
1	Plot 1
2	Plot 2
3	Plot 3
4	Plot 4
5	Plot 5
6	Plot 6
7	Plot 7
8	Plot 8
9	Plot 9
10	Plot 10