

NOTE:-

1. THIS REVISED PART LAY OUT PLAN FOR COMMUNITY CENTER HAS BEEN PREPARED AS PER INFORMATION RECEIVED FROM EX. EN., C.D.-17, VIDE HIS LETTER NO. 2131 / Y-4 / 10, DT. - 28.07.2015 AND AS PER THE DECISION TAKEN BY COMMITTEE (FRAMED UNDER THE ORDER OF HOUSING COMMISSIONER) DATED -06.11.2015 AND AS PER INSTRUCTIONS GIVEN ORALLY BY H.C. AND ADDLL.H.C.
2. LAND NOTIFICATION WAS PUBLISHED IN TWO LOCAL NEWS PAPER OF BANDA (NEWS DAILY IN HINDI AND HINUSTAN TIMES IN ENGLISH) FOR OBJECTION / SUGGESTIONS FROM PUBLIC BUT NO OBJECTION / SUGGESTIONS HAVE BEEN RECEIVED TILL DATE.

SCHEME

BANDA BHOOMI VIKAS & GRIHSTHAN YOJNA AT BANDHA.

PROJECT

PART LAYOUT PLAN FOR HEALTH CENTRE IN SECTOR - A

DATE : 21.01.2016

NORTH

SCALE : 100 5.0 0 10.0 25.0M

MADHULIKA SRIVASTAV
 A.I.A.
 ARCH. ASSTT. SD.

JYOTI KATIYAR
 B.ARCH.
 ASSTT. ARCH. PLANNER

ARVIND DEO ARYA
 B.ARCH.,A.I.I.,A.M.,A.M.B.A.(PM)
 ARCHITECT PLANNER SD./22.1.16

CHIEF ARCHITECT PLANNER SD.

SHAHABUDDIN MOHAMMED
 I.A.S.
 AVAS AYUKT SD.

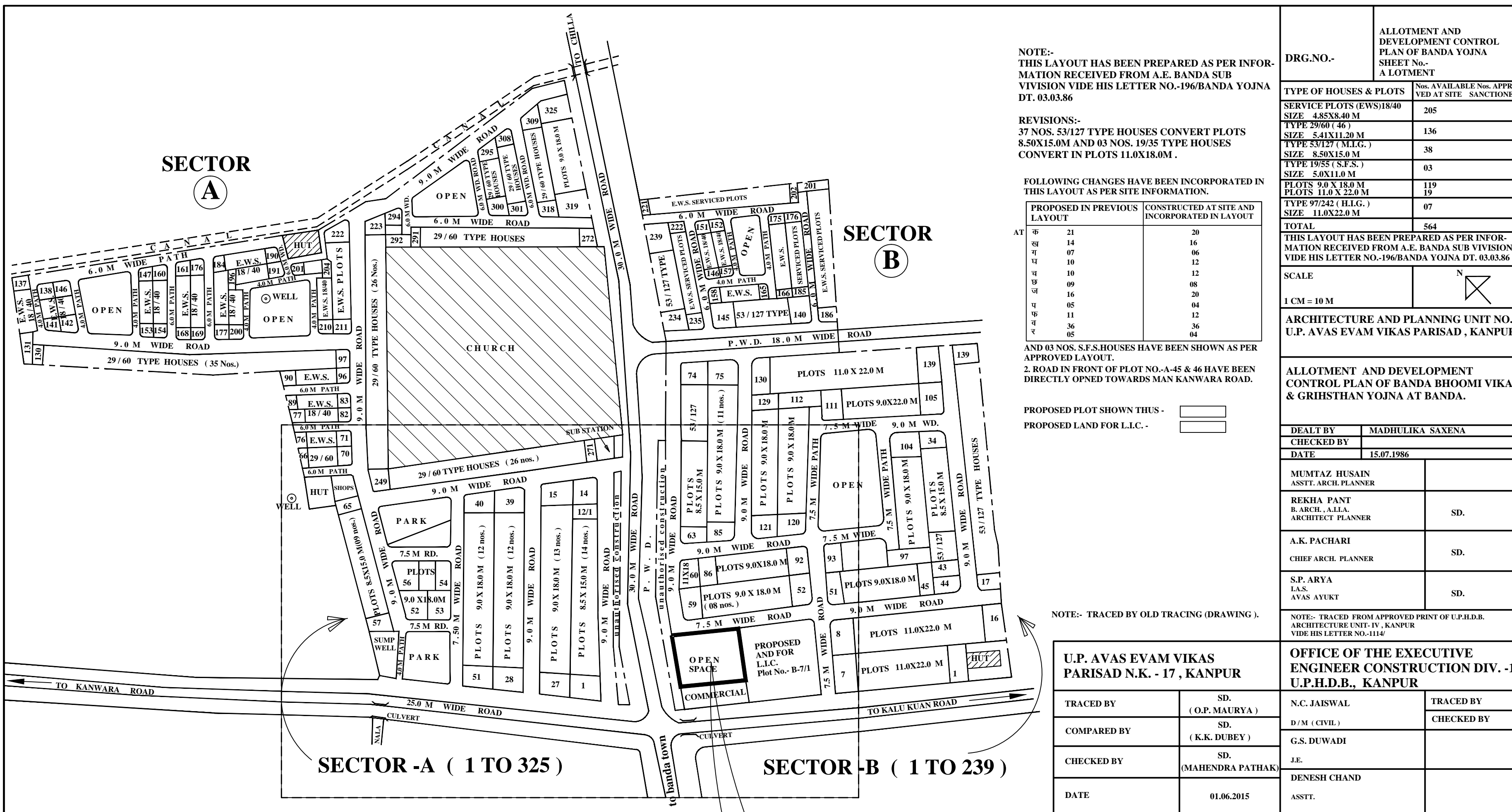

NOTE:- THIS DRAWING HAS BEEN TRACED FROM THE LAYOUT PLAN DULY APPROVED BY THE THEN HOUSING COMMISSIONER DATED 17.11.2013.

KEY PLAN

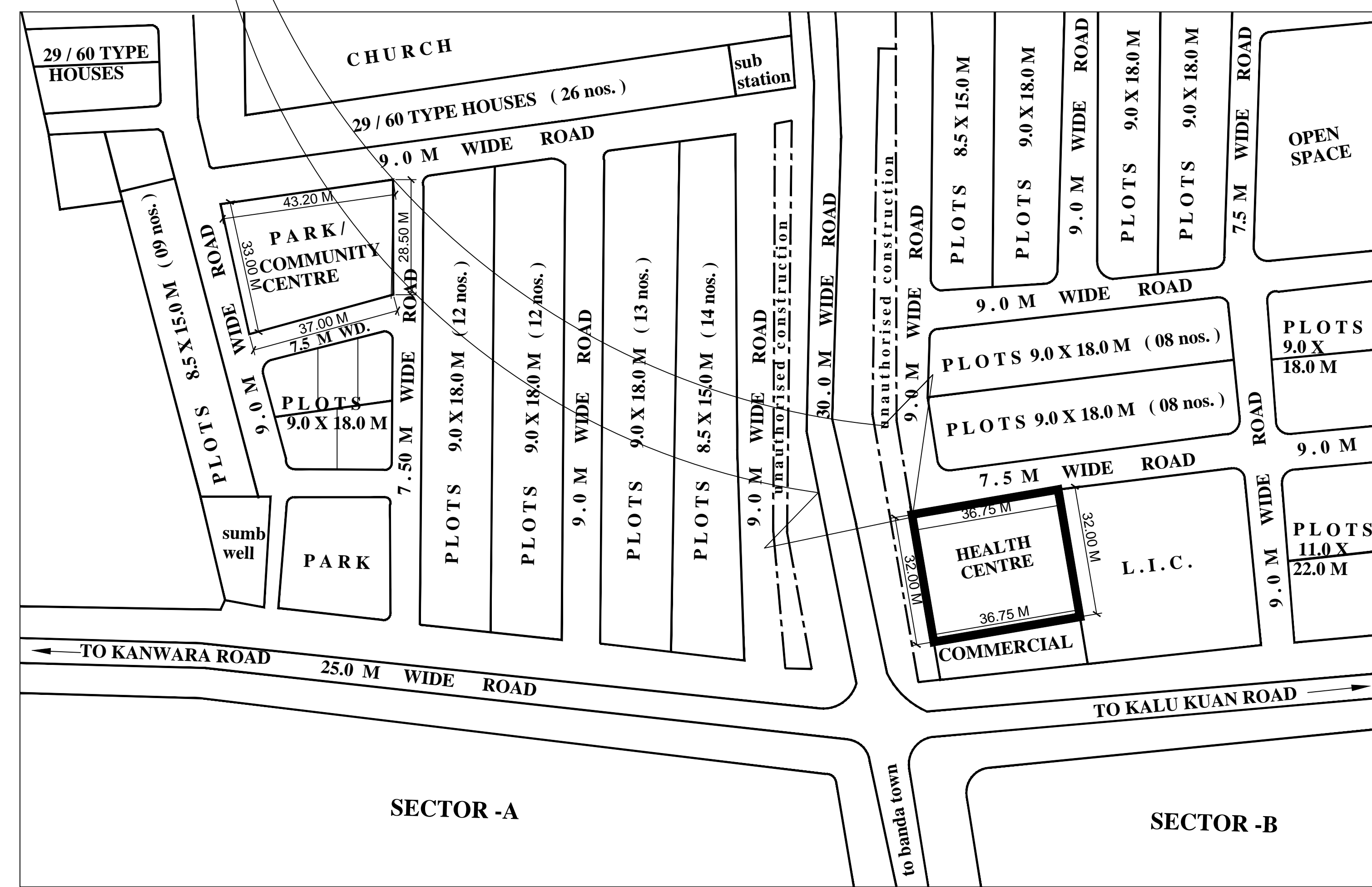

PART LAY OUT PLAN