

UPAVP
 ARCHITECTURE AND PLANNING UNIT-7
 NEELGIRI COMPLEX, INDIRA NAGAR
 LUCKNOW-226016
 Email : architectplanner7@gmail.com

DRG. NO.
 UPHDB/APD/APUnit-7/CD-18/SE-4/KAN/Y-2/Sec-7/
 R.LOP/HC/02.09.16/S-01/56

REVISION NOTE:-

1. THIS REVISED PART LAY OUT PLAN HAS BEEN PREPARED ON THE BASIS OF THE PROPOSAL RECEIVED FROM D.H.C., KANPUR ZONE , VIDE HIS LETTER NO.- 398 / KANPUR ZONE , DT. - 28.06.2016 AND THE INSTRUCTION GIVEN BY A.H.C. (PROPERTY-HQ.) DURING THE MEETING HEADED BY HIM DATED 12.07.16 AND IN REFERENCE WITH THE TELEPHONIC CONVERSATION WITH S.E. CIRCLE-IV DATED 12.07.2016.

2. THE FOLLOWING REVISION HAS BEEN DONE-

*GROUP HOUSING PLOT NO.- 7 / G.H.-02 HAS BEEN DIVIDED IN TO TWO PLOTS (7/G.H.-02 AND 7/COM-02/1) HAVING PROPERTY LINES AT A DISTANCE OF 2.0 M FROM THE EXISTING H.T. LINES DUE TO EXISTING H.T. LINES ON SITE .

3. THIS REVISED PART LAY OUT PLAN HAS BEEN FINALIZED ON THE BASIS OF THE FEASIBILITY RECEIVED FROM E.E., CD-18 VIDE HIS LETTER NO.- 1511 / Y-5 / 394 DT. - 23.08.2016 .

SCHEME

HANSPURAM YOJNA NO.- 2 , KANPUR .

PROJECT

REVISED PART LAYOUT PLAN FOR THE GROUP HOUSING & COMMERCIAL PLOT AT SECTOR - 7.

DATE : 01.09.2016



SCALE :

P.C.K. Maurya
 A.I.I.A.
 ARCH. ASSTT.

sd : 01.09.2016

REKHA DIXIT
 DIP.ARCH. ,
 ASSTT. ARCH. PLANNER

sd : 02.09.2016

ARVIND DEO ARYA
 B.ARCH.A.I.I.A.M.A.M.B.A(PM)
 ARCHITECT PLANNER

sd : 02.09.2016

CHIEF ARCHITECT PLANNER

sd : 02.09.2016

RUDRA PRATAP SINGH
 I.A.S.
 AVAS AYUKT

sd : 02.09.2016

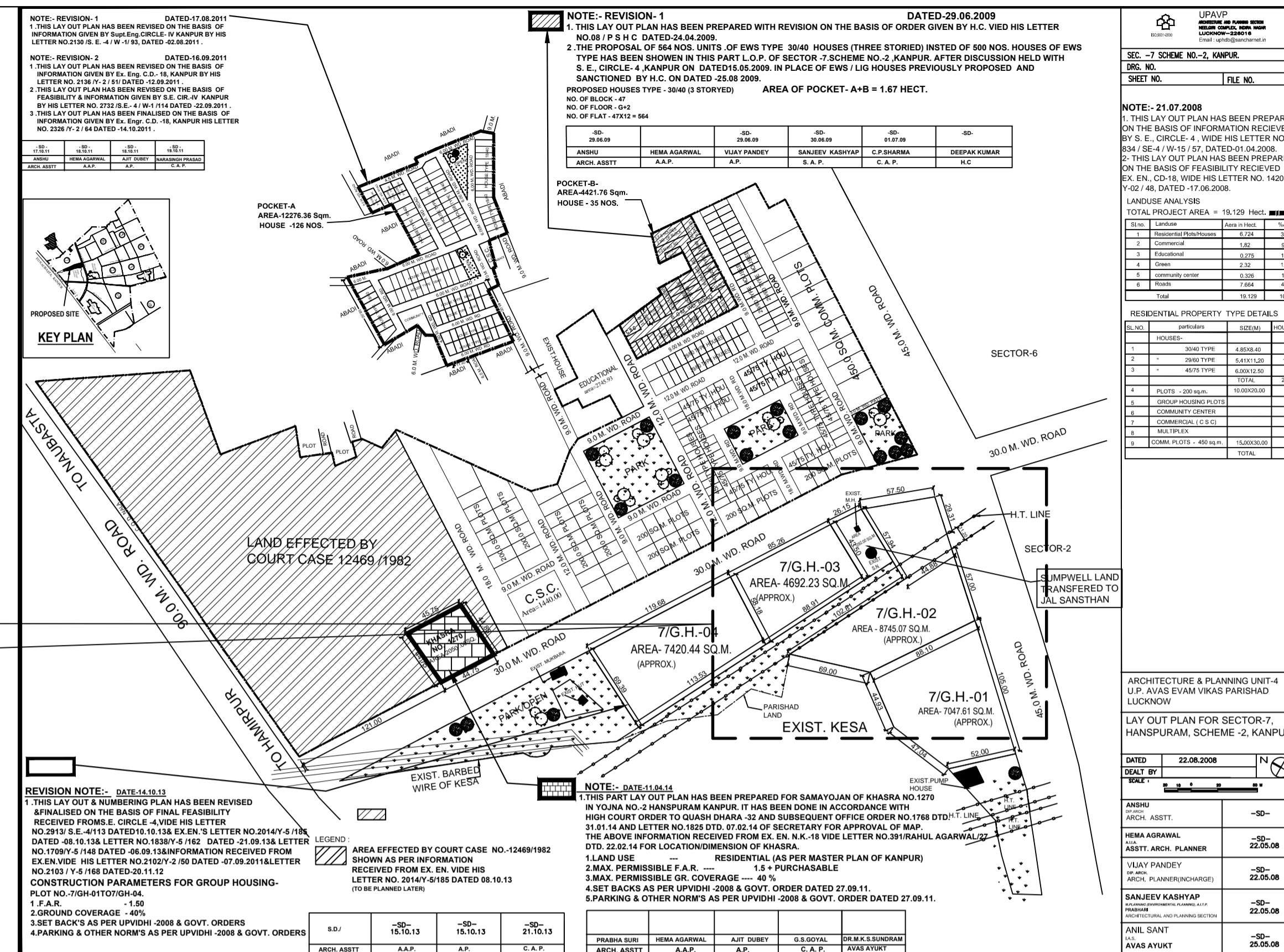

LAY-OUT PLAN

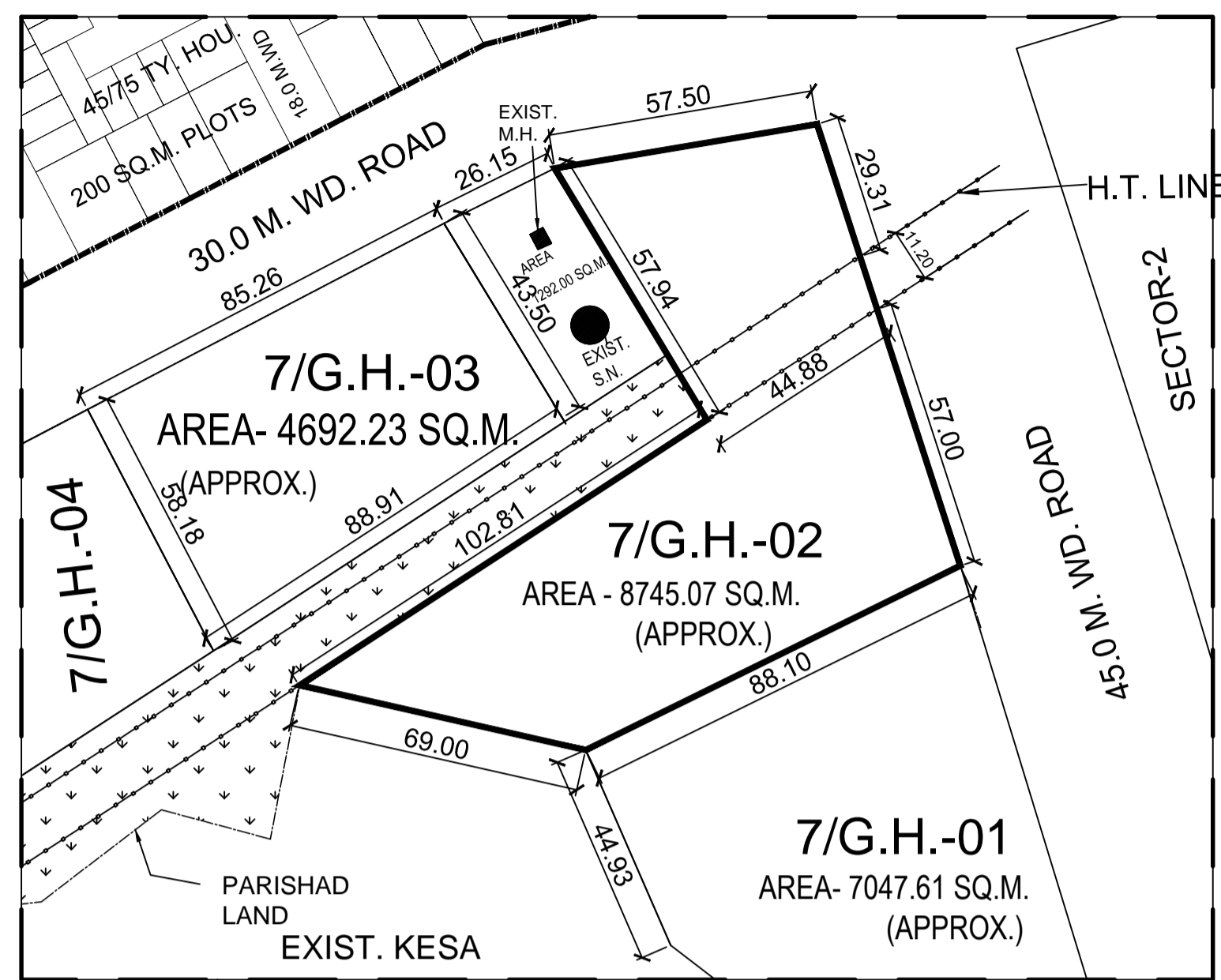

PART LAY-OUT PLAN

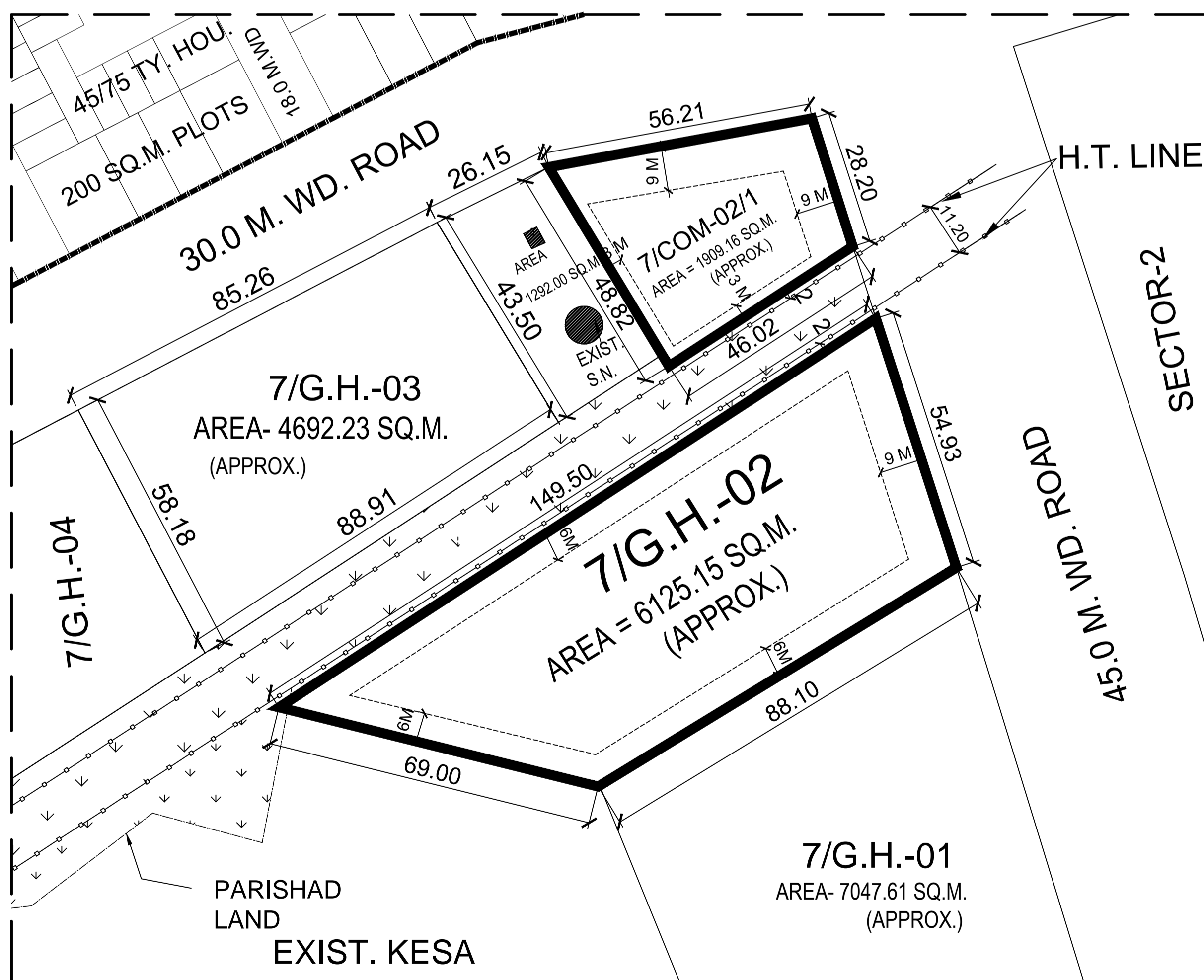

LAY-OUT DETAIL

CONSTRUCTION PARAMETER FOR GROUP HOUSING PLOT NO.- 7/G.H.-02

- # Ground Coverage (max.) = 40%
- # F.A.R. (max.) = 1.50
- # Set back - (Mandatory upto 18.0 M Building ht. otherwise as per article 3.4.5 of upvidh 2008)

Front = 9.0 m	Rear = 6.0 m
Side-1 = 6.0 m	Side-2 = 6.0 m

CONSTRUCTION PARAMETER FOR COMMERCIAL PLOT NO.- 7/COM-02/1

- # Ground Coverage (max.) = 40%
- # F.A.R. (max.) = 1.20
- # Building Height (max.) = 10.00 m
- # Set back -

Front = 9.0 m	Rear = 3.0 m,
Side-1 = 3.0 m	Side-2 = 9.0 m

ALL THE NORMS AS PER UPVIDHI -2008.

THIS DRAWING OF LAY OUT PLAN HAS BEEN TRACED DT. 18.09.2017. - P.C.K.MAURYA ,(CHECKED BY -AAP)

PROPOSED SITE

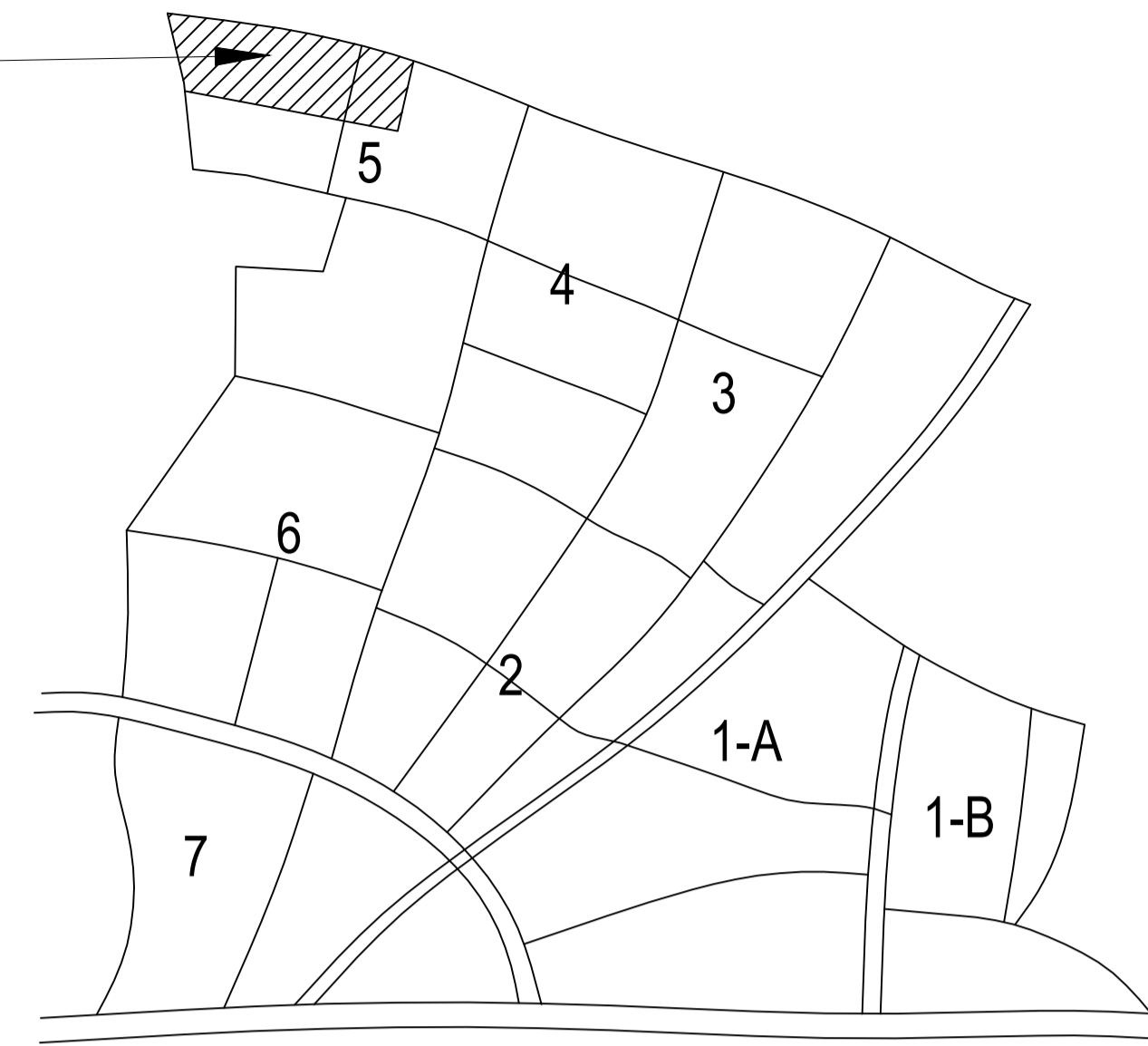

KEY PLAN (NOT TO THE SCALE)

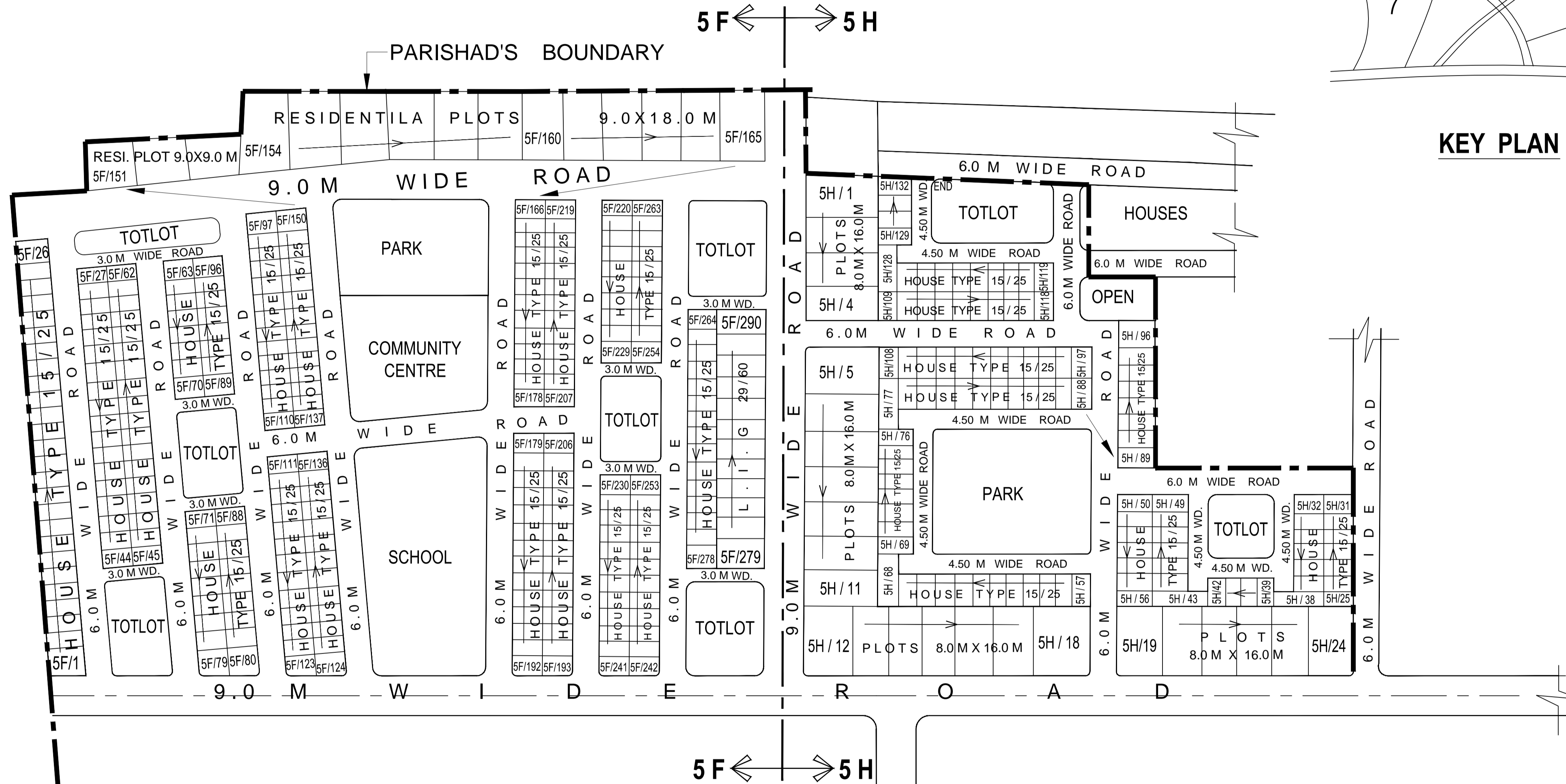

NOTE :-
THIS NUMBERING LAY OUT PLAN HAS BEEN PREPARED ON AS PER INFORMATION SENT BY E.E., C.D.-18 VIDE LETTER NO.- 275/Y-2/13 DATED- 01.02.2002 PROPOSED PLOTS ONLY .

NOTE :-
9.0 M. WIDE ROAD NEAR NORTHEN BOUNDARY HAS BEEN RE-ALIGNED AS PER REPORT SENT BY E.E., C.D.-18 VIDE HIS LETTER NO.- 275/Y-2/13 DATED- 01.02.2002

DRG. NO.	ASHRAYA YOJNA KANPUR
	SHEET NO.
	PART LAY OUT PLAN

SCHEME AREA = 3.27 HECT.

LAND USE ANALYSIS :-

S.No.	USE	AREA (HECT.)	% AGE
1.	RESIDENTIAL	1.31	40.06
2.	OPEN	0.47	14.37
3.	SCHOOL	0.14	4.28
4.	COMM. CENTRE	0.09	2.75
5.	ROAD	1.26	38.54
TOTAL			100.00

NOS. OF HOUSES / PLOT = 422 Nos.
DENSITY = 664 P/H
OPEN SPACE REQUIRED = 18 %
OPEN SPACE PROVIDED = 14.37 %

NOTE :
REMAINING OPEN SPACE TO BE PROVIDED IN AREA YET TO BE PLANNED.

SCALE - 1 : 1000

N



ARCHITECTURE AND PLANNING UNIT - IV
U.P. AVAS EVAM VIKAS PARISHAD, LUCKNOW.

PART LAY OUT PLAN OF ASHRAYA YOJNA SECTOR-5 , SCHEME NO.- 2 , KANPUR .

DEALT BY	SHAHEENA
CHECKED BY	
DATE	18.12.99
AJIT DUBEY B.ARCH. ASSTT. ARCH. PLANNER	Sd..
SARFARAZ AHMAD B.Sc., B.ARCH., F.I.I.A. ARCHITECT PLANNER	Sd 18.12.99
SUBODH SHANKER B.ARCH.(HONS.), F.I.I.A., F.I.T.P. CHIEF ARCH. PLANNER	Sd 18.12.99
N. RAVI SHANKER I.A.S. AVAS AYUKT	Sd 20.12.99

sd... 02.03.2002	sd...	sd... 02.03.2002
A. K. SINGH A. A. P.	SARFARAZ AHMAD A. P.	SUBODH SHANKER C. A. P.

sd... 28.02.2002	sd... 28.02.2002	sd... 28.02.2002
A. K. SINGH A. A. P.	SARFARAZ AHMAD ARCH. PLANNER	SUBODH SHANKER CHIEF ARCH. PLANNER